

Cal Monarch

Office Systems Division



California Wire Products Corporation

Made in USA



PANEL TYPES
AVAILABLE
IN 2" OR 3"

STD. INSULATED

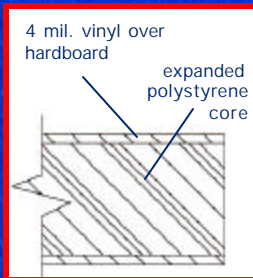

CLEANROOM

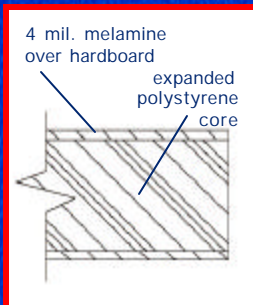

FIRE RETARDANT

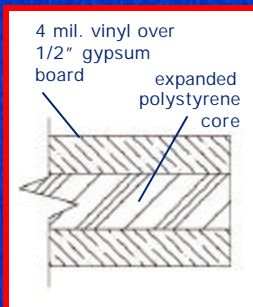

EXTERIOR

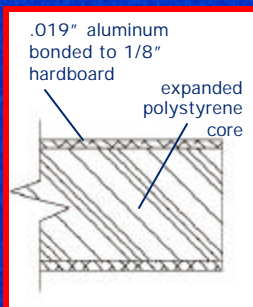

STD. COLORS

ALMOND

MATTE GRAY

WHITE



STANDARD 2" IN-PLANT OFFICE

MAXIMIZE YOUR
FLOOR SPACE

Cal Monarch Two-Story Office Systems allow for maximum use of available floor space.

Second story provides a clear view of the work area below.

Contact your local rep. for further information and a FREE quote!

GUARD SHACK
EXTERIOR OR INTERIOR



SAVE TIME AND MONEY

With Cal Monarch's project-specific Autocad drawings and easy-to-understand installation instructions your office can be installed in a speedy fashion.

The simple modular design allows you to make changes or relocate very easily.

Our in-plant offices offer outstanding value and convenience and are available in 2" or 3" thick wall systems.

Ask your rep. for a quote on both!

TWO-STORY OFFICE
WITH CAL GUARD RAIL



GUARD SHACKS FOR
ADDED SECURITY

Portable guard shacks provide added security and access control.

They can be built to any size to meet your needs, fully assembled on a forkliftable base, or disassembled with easy-to-follow installation instructions.

COUNTLESS APPLICATIONS!

With Cal Monarch's quality and flexibility the applications are endless! These applications include: in-plant offices, guard shacks, reception offices, cleanrooms, conference rooms, lunch rooms, storage, first aid stations, computer rooms, quality control centers, personnel offices, equipment rooms, and display areas.



NEW 45° CORNER DESIGN !

CONFERENCE ROOM



CUSTOM DESIGN - QUALITY YOU CAN COUNT ON!

Cal Monarch's in-house engineers can configure a custom system to meet your needs. Cal Monarch uses the finest USA-made materials to manufacture its office systems. With over 25 years experience you can be confident that you are getting the highest quality product. We can build your office to meet seismic and safety codes and offer a one year warranty.

OFFICESCAPE PARTITIONS

Cal Monarch Officescape Partitions are easily de-mountable so you can avoid the time, expense, and inconvenience of conventional drywall construction. Our Officescape partitions are durable, functional, and attractive. Ceiling height partitions are available for privacy and security.

OFFICESCAPE PARTITIONS



CAL WIRE VALUE

When you place an order with Cal Wire, not only are you guaranteed the highest quality product, you are assured of receiving unsurpassed service and VALUE:

- * Free estimate
- * Free freight quote upon request
- * In-house Engineering and Customer Service Departments
- * Protective packaging
- * Forkliftable enclosed crate
- * All assembly hardware
- * Electrical outlets and switches
- * Instructions
- * Detailed project-specific CAD drawings
- * Installation Instructions
- * Quick lead times
- * One year warranty

Cal Guard Rail

Creating a safe work environment is one of the most sound investments a company can make. That is why the Cal Guard Rail System is essential to any warehouse or factory. It protects your most valuable assets - employees, customers, machinery, and the walls of your facility.

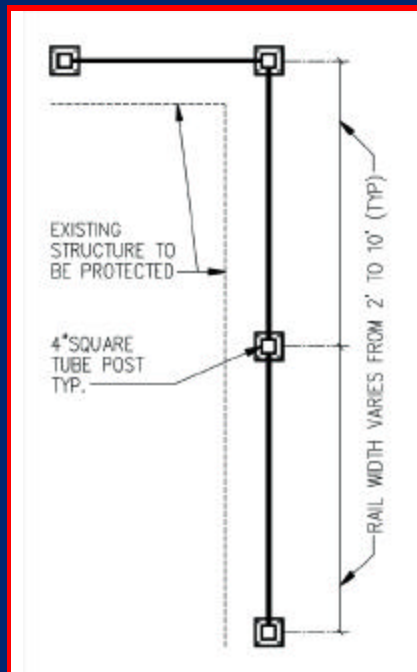
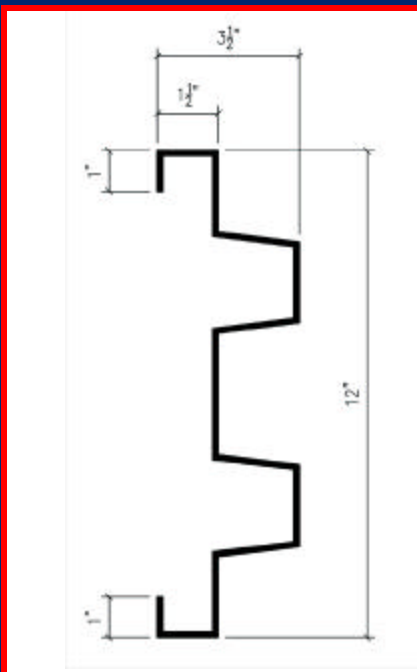

Rail Sections - shall be made from 12 gauge steel and shall meet ASTM requirements.

Mounting Posts - shall be 4" x 4" x 3/16" square structural steel tubing with 8" x 8" x 1/2" steel base plates.

Hardware - to include four 1/2" x 6" machine bolts, nuts, and washers.

Anchors - four 1/2" x 5" wedge anchors per post. Posts also include 4" x 4" decorative plastic insert caps.

MEETS CODE

Cal Guard Rail is available in a single (18" high) or double (44" high) rail system. The rolled returns at the top and bottom meet necessary safety requirements.

ECONOMICAL

Cal Guard Rail can be purchased and installed more economically than in-house, custom-fabricated barriers. They restrict possible costly injury or damage to personnel, equipment, and facility walls.

APPLICATIONS

Cal Guard systems can be used to protect aisleways, building walls, equipment, loading docks, electrical equipment, and inventory.

Stock No.	Description	Wt. Lbs.
GR 10	10' rail	80
GR 8	8' rail	64
GR 6	6' rail	48
GR 5	5' rail	40
GR 4	4' rail	32
GR 2	2' rail	16
SGRP	4" x 3/16" sq. tube x 18"	33
DGRP	4" x 3/16" sq. tube x 44"	53

CALIFORNIA WIRE PRODUCTS CORPORATION

1128 West Bradford Circle · Corona CA 92882
 (909) 371-7730 · (800) 486-7730 · FAX (909) 735-1070
 Website: www.cawire.com · E-mail: info@cawire.com

DISTRIBUTED BY: